

2017 Stamp-A-Palooza!

Double Flap Fun Fold Card



Card designed by Dee Slater and Davette Miller

Stamp

- [Season To Sparkle Photopolymer Stamp Set \[144943\]](#)

Ink

- [Brights Stampin' Write Markers \[131259\]](#)
- [Pumpkin Pie Classic Stampin' Pad \[126945\]](#)

Card Stock

- [Basic Black 8-1/2" X 11" Card Stock \[121045\]](#)
- [Spooky Night Designer Series Paper \[144610\]](#)
- [Silver Glimmer Paper \[135314\]](#)
- [Very Vanilla 8-1/2" X 11" Card Stock \[101650\]](#)

Tools & Adhesive

- [Tear & Tape Adhesive \[138995\]](#)
- [Stampin' Dimensionals \[104430\]](#)
- [Liquid Multipurpose Glue \[110755\]](#)

Punch

- [2" Circle Punch \[133782\]](#)
- [Cat Punch \[144666\]](#)

Accessory

- [Clear Wink Of Stella Glitter Brush \[141897\]](#)

Big Shot

- [Layering Circle Framelits Dies \[141705\]](#)
- [Big Shot \[143263\]](#)
- [Woodland Textured Impressions Embossing Folder \[139673\]](#)

Bundles

- [Seasonal Chums Clear-Mount Bundle \[146077\]](#)

Material Cuts:

Basic Black: (2) 5 ½ x 4 ¼, 6 x3, 6 x 1

Pumpkin Pie: Scrap for cat punch

Very Vanilla: 5 ½ x 2 1/2 , Scrap to stamp pumpkin image

Silver Glimmer Paper: 2 ½ x 2 ½ to die cut scallop frame, 5-1/2 x 1/8

Designer Paper: 5 ½ x 3 ½ , 6 x ¾ , DP with cat image

Steps to Make:

1. Emboss your 6x3 Basic Black with the Woodland Embossing Folder – set aside.



2. Adhere designer paper and silver glimmer paper strip on one of the 5 ½ x 4 ¼ pieces of basic black cardstock. Flush designer paper to left side of base. Add silver accent to right of designer paper.



3. Line up the embossed piece of basic black and fold over top of base. Add strip of Tear & Tape and adhere flop to base. (Tip – please see video tutorial ☺ hard to show in pictures.)



4. With 2 inch Circle Punch, punch hole on basic black flap. Add silver glimmer frame made out of layering circles Framelits.
5. Position Very Vanilla base layer so that it aligns beneath the basic black with hole/window. Make sure no very vanilla cardstock shows when black piece closed.



6. Close flap and stamp sentiment through window.



7. Stamp, color and die cut pumpkins. Add wink of Stella for a little glimmer! Cut off the string hole part of the pumpkin. Fold – add Dimensionals foam dots and add to the window as shown.

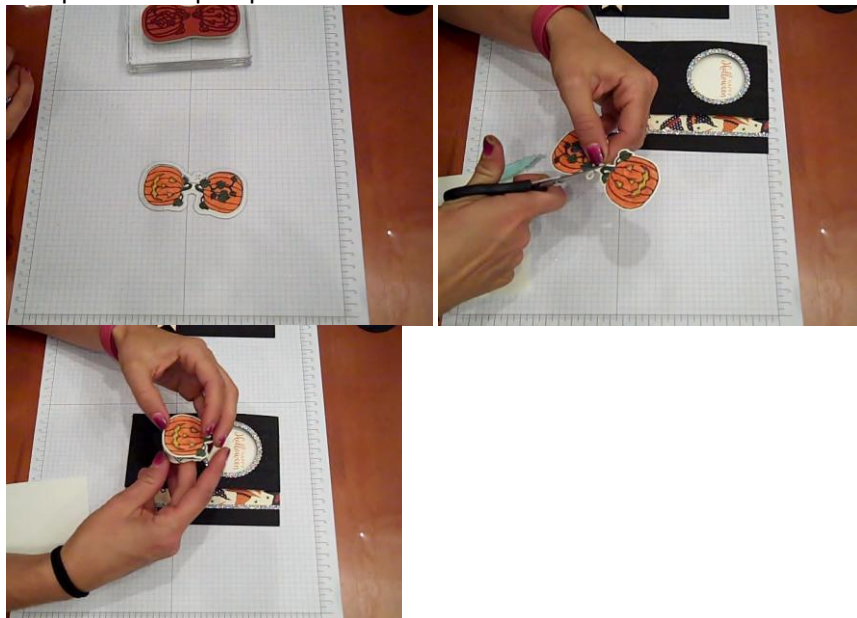

8. Now we are ready to make the 2nd flap! Cut a banner tail in both pieces of the flap and glue together. Position the strip and fold around the left side of the base to get the back tab. Add tear & tape to the back tab section.



9. Last step is to add the cat images. Punch cat from designer paper for front and punch cat from pumpkin pie cardstock for back. Position cat to the right part of strip. Use Dimensionals to add cat images.

